



2017

TABLE OF CONTENTS

Introduction	2
General Information	5
Map	7
Sponsors	12
Thursday, October 12	18
Friday, October 13	18
Saturday, October 14	22
Sunday, October 15	27
Posters	32
First Timer's Guide to ELC	35
ACAPT Consortium Descriptions	36
Education Section SIG Descriptions	38
Exhibitor Descriptions	39
Notes	42

INTRODUCTION

Dear Colleagues:

Welcome to Education Leadership Conference (ELC) 2017! This year's overarching theme **“Through the Looking Glass: Transforming Physical Therapy Education”** encourages us to look to the future while learning from the past. The ELC is a collaborative effort of the Education Section and the American Council of Academic Physical Therapy (ACAPT) designed to excite, educate, invigorate, and facilitate discussion among all stakeholders in physical therapy education. The success of this conference lies with our shared passion for excellence in physical therapy education as well as the active participation of all of you - DPT program directors and chairs, PT and PTA educators, directors of clinical education, clinical instructors and center coordinators, faculty, and residency/fellowship educators.

ELC 2017 features several very special celebrations and events. On Thursday evening, CAPTE invites you to join their 40th Anniversary celebration with a reception from 5:30-7:30 PM. On Saturday afternoon, don't miss the rowdy Oxford Debate arguing the merits of appearance in *The Image We Send: Does it Matter?* Saturday evening is the 25th Anniversary for the Celebration of Diversity dinner at the Franklin Park Conservatory and Botanical Gardens (tickets are still available!) Proceeds from the Diversity dinner go to the Minority Scholarship Fund which has awarded more than \$943,000 to 230 physical therapist and physical therapist assistant students and fourteen (14) faculty members pursuing a doctoral degree since the fund was established in 1987.

ELC 2017 includes a variety of meetings, including the ACAPT open forum, ACAPT business and consortia meetings, and Education Section Special Interest Group (SIG) meetings. Brief descriptions of the SIGs and consortia are in the **First Timers Guide to ELC** on page 29 of this program. Both the Education Section and ACAPT are proud members of the Education Leadership Partnership (ELP), which is a collaborative of members of the APTA, the American Council of Academic Physical Therapy, and the Education Section, committed to the common objective of reducing unwarranted variation in physical therapist practice through use of best practices in education.

Our programming includes platform presentations, 90-minute educational sessions, and 4 distinct poster sessions held during each exhibitor break

on Friday and Saturday. This year, our educational programming features a variety of topics related to 5 exciting themes:

- Humanities: Bringing art and evidence into PT education
- Walking the Talk: Leadership and advocacy
- Using evidence and benchmarks in curricula planning
- Strengthening clinical reasoning and interprofessional skills during internships
- Admissions perspectives and challenges: Where are we now?

Formal programming opens Friday morning with the 4th annual Dr. Geneva R. Johnson **Forum on Innovation in Physical Therapy Education** entitled *"Disruptive Innovation in Physical Therapy Education: Why a shift of focus is essential to add value to the emerging health care system?"* It begins with a provocative keynote address by Shafik Dharamsi, PhD, Dean, College of Health Sciences, University of Texas at El Paso. Immediately following, individuals representing three unique educational perspectives (that of faculty, clinician/residency, and administrator) briefly respond to Dr. Dharamsi's session to IGNITE further discussion. Following a 30-minute exhibitor break with poster presentations, participants can continue the conversation during the café style discussions based on the topics brought forth in the keynote and IGNITE sessions or attend a variety of concurrent educational programming.

The ELC is an intimate conference designed with many opportunities to relax and engage in collegial discussions, meet physical therapy educators from across the country, and spend time meeting our exhibitors and sponsors. On Friday and Saturday morning, join us for Breakfast with Exhibitors. We also have two additional exhibitor/poster sessions on Friday and Saturday! Take the opportunity to grab some refreshments and meet with exhibitors and colleagues.

As outgoing program co-chairs, we thank you for the privilege of serving in this capacity. Moving forward, you will be in the very capable hands of Debbie Ingram (ACAPT Program Chair) and Danille Parker, (Education Section Program Vice Chair). We greatly appreciate the support of Gina Musolino, Education Section President, and Barb Sanders, ACAPT Chair. We are thankful for the many volunteers who served as peer reviewers for the educational programming abstracts and to those who are volunteering

during the onsite program as moderators. Last, but certainly not least, we recognize and applaud the collective efforts of an amazing team of individuals who attend to every detail of this conference. These outstanding individuals include: Sandy Rossi, Executive Director for ACAPT; Julia Rice, Executive Director for the Education Section; Christina Fontana, APTA Meeting Planner; Education Section Programming Committee Members: Lisa L. Black, Lisa L. Dutton, Scott Euype, Cindy Flom-Meland, Kathrine Giffin, Jay Lamble, Jennifer Mai, and Donna Skelly) and ACAPT Programming Committee Members: Katherine Beissner, Debbie Ingram, Caroline Goulet, and Scott Ward, Director at Large.

Have a wonderful conference! Don't hesitate to ask questions at the registration desk, to event volunteers, or to hotel/conference staff. We look forward to your active participation during the conference and appreciate your feedback!

Sincerely,

Mary T. Blackinton PT, EdD

ACAPT, Program Committee Chair

April D. Newton PT, DPT, FNAP

Education Section, Program Chair

SAVE THE DATE

ELC 2018
October 12–14 • Jacksonville, Florida

ELC 2019
October 18–20 • Bellevue, Washington

APTA Staff Are Committed to Providing Exceptional Service

The Educational Leadership Conference (ELC) 2017 team of APTA staff are here to assist you throughout the conference. Feel free to stop any APTA staff member (identified with the staff badge) or visit the ELC registration area with questions or concerns. We're here to make your ELC experience of learning and networking an enjoyable one.

Christina Fontana
Julia Rice
Sandy Rossi

Internet Access

1. Connect to the following wireless network: **HyattMR**
2. Open your web browser.
3. This will automatically take you to our login splash page. If not, please type www.psav.com into your address bar and press enter. You should now see the splash page. If you still cannot reach the splash page, please make sure you are connected to the correct wireless network.
4. Enter the following case-sensitive password: **ELC2017**

Electronic Devices

Please be considerate of speakers and other attendees by turning off your cell phones during sessions.

Exhibit Hall

Be sure to visit the Exhibit Hall for access to companies and vendors displaying an array of products and services. This is your chance to talk to industry experts and to discover new, innovative physical therapy products and services!

Please see page 39 for complete information and exhibitor descriptions.

Breaks with the Exhibitors

Friday: 7:00 am – 8:00 am / 10:00 am – 10:30 am /
12:30 pm – 1:30 pm / 3:00 pm – 3:30 pm / 6:30 pm – 8:00 pm

Saturday: 7:00 am – 8:00 am / 10:00 am – 10:30 am / 12:00 pm – 1:15 pm
/ 4:30 pm – 5:00 pm

Registration Hours

Thursday, October 12 4:30 pm – 8:00 pm
Friday, October 13 7:00 am – 5:00 pm
Saturday, October 14 7:00 am – 5:00 pm
Sunday, October 15 7:00 am – 12:00 pm

Continuing Education Units & Verification of Attendance

ELC 2017 attendance is equivalent to 1.75 Continuing Education Units (CEUs) (17.5 contact hours); this amount will be reflected on your certificate of participation. We have applied for CEU approval in Ohio, New York, California, and Texas and are recognized in most states.

If your state requires additional verification of attendance at each session, please have your conference onsite program signed under each session you attend. A designated representative will be available at the end of each session. Please save your onsite program as proof of attendance. While we are able to confirm your conference registration, we are not able to confirm your attendance at specific sessions. For information on continuing education requirements and procedures in your state, visit APTA's webpage for state practice acts (www.apta.org/Licensure/StatePracticeActs/).

Course content is not intended for use outside the scope of the learner's license or regulation. Clinical CEUs should not be taken by individuals who are not licensed or otherwise regulated, except if they are involved in a specific plan of care.

Accessing Your Continuing Education Certificate

Continuing Education Certificates for ELC 2017 will be distributed through APTA's Learning Center after November 1, 2017. Additional CEU approval information is listed above. To access your certificate, please follow the instructions below:

1. Login to <http://learningcenter.apta.org>
2. If you do not know your login information, please contact member services at 800/999-2782 or MemberServices@apta.org. Typically, your user ID will be your APTA member ID or email address. If you do not remember your password, please use the Forgot Password link.
3. Under My Learning Activities, select My Courses
4. Select Details to enter the evaluation
5. After successfully completing the evaluation, you may download your certificate by clicking on "certificate."

Questions can be directed to the Learning Center at 800/999-2782.

FLOOR PLAN/MAP

SECOND FLOOR

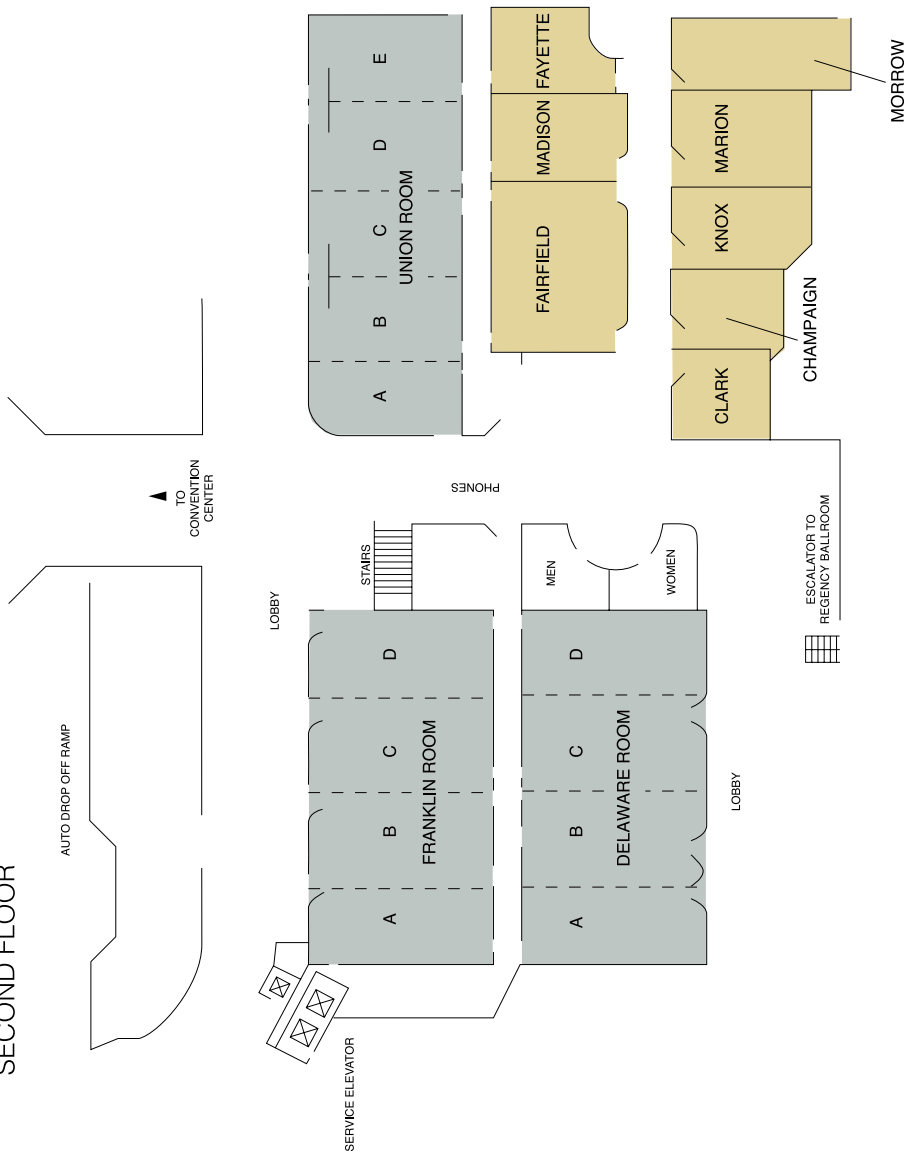

FLOOR PLAN/MAP

REGENCY BALLROOM AND EXHIBIT ROOM THIRD FLOOR

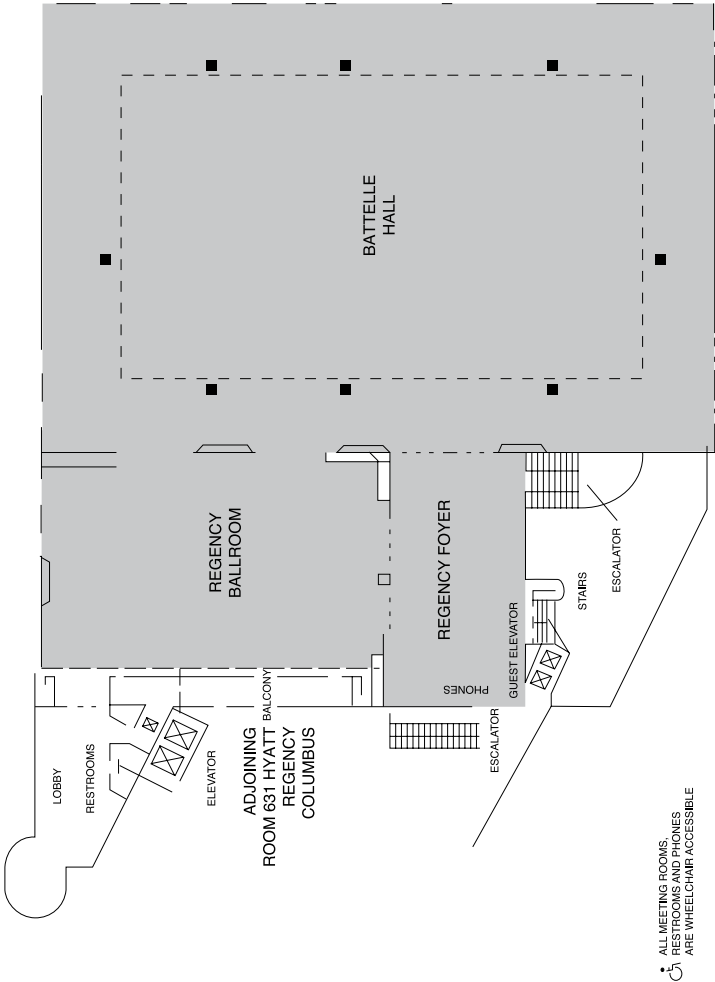

FLOOR PLAN/MAP

UNION ABC AND EXHIBIT HALL

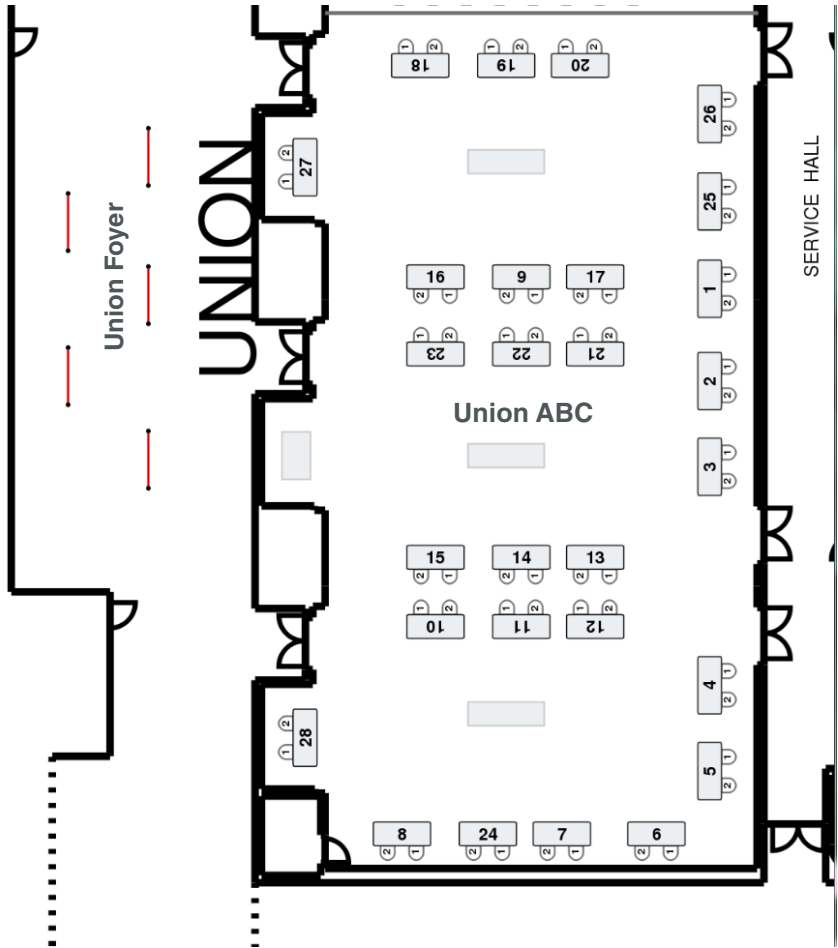

2018-2019 APTA Conferences

Save the date and be a part of the action at these upcoming conferences!





WE LISTEN DESIGN MANUFACTURE

cardonrehab.com

“ I HAVE TAUGHT IN
26 DIFFERENT COUNTRIES
AND HAVE NOT SEEN A
TABLE OF THIS QUALITY. ”

*Professor Laurie Hartman, DO, PhD
Associate Professor of Osteopathic Technique,
British School of Osteopathy*



CARDON
cardonrehab.com



1-800-944-7868



quotes@cardonrehab.com

SPONSORS

SPECIAL THANK YOU TO THE FOLLOWING SPONSORS!

PLATINUM



GOLD



SILVER



SPONSORS

BRONZE

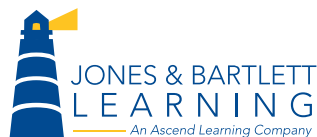

PT Cardiopulmonary Educators

Convenient cardiopulmonary education for busy PTs and PTAs



Ohio Kentucky Consortium of Physical Therapy Programs for Clinical Education



NATIONWIDE CHILDREN'S

When your child needs a hospital, everything matters.™

SCOREBUILDERS

BETTER
PRODUCTS...
BETTER
OUTCOMES

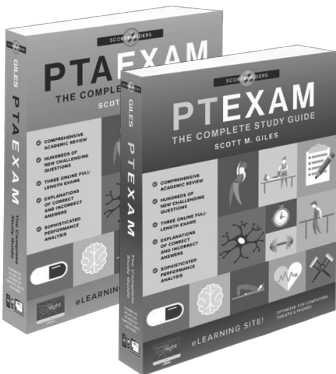



TherapyEd
www.TherapyEd.com

Get the Confidence of our Experience

- For over 25 years **TherapyEd** has been the leader in helping students prepare for and pass the National Physical Therapy Exam. With the best instructors, the most rigorous practice questions, and the #1 best-selling *Review & Study Guide*, **TherapyEd** is the best choice to help their students succeed.
- **TherapyEd's** Prep Classes provide students with the most comprehensive resources and effective tools for passing the NPTE the first time.
 - Experienced instructors
 - 350 page Course Manual included
 - Online Office Hours after the course
- New, 21st edition of TherapyEd's NPTE *Review & Study Guide* by O'Sullivan and Siegelman. Revised and completely updated for the new exam blueprint.

Save up to 25%: Host a Class or purchase TherapyEd's *Review & Study Guide* as a class!

Contact: Brett Bennett, TherapyEd

888-369-0743 x17

bbennett@TherapyEd.com

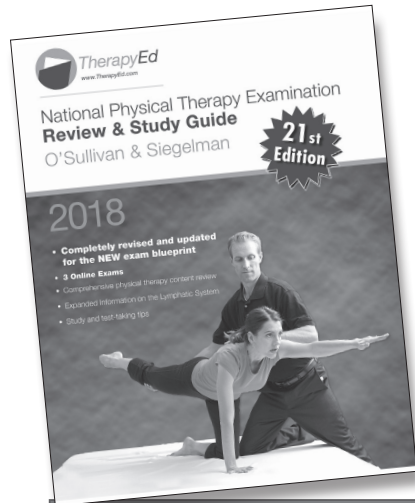

This course was extremely beneficial for my exam preparation and understanding of the exam structure and content. I feel so much better after taking this course — it has empowered me to prepare for the most important exam of my life!

- Taylor S., Trine University

The instructor had fantastic energy, focus, and determination to provide us with the best experience possible. I felt like I learned more in these two days than I did in some classes over an entire semester. I like having a concrete study plan in place.

- Jeanette J., University of St. Augustine-Texas

Host a Class On-Campus and Save!

www.TherapyEd.com



acadaware

Academic Software Solutions for
Experiential Learning Programs

Acadaware is Your Central Hub for Data Management



University

- Clinical Education (CE)
- Curriculum Mgmt. (CM)
- Assessment (4 sections)
- Clinic Site Placement
- Contract Management
- Effective Communications
- Track and Manage Student Requirements
- Integrated Central Database
- Effortless Prep for Accreditation
- Assume the role of the student via student website

University

Connecting
the
Information
Loop

Clinic



Clinic

- Facility Information Form "FIF" manages Clinical Sites Updates, and Requirements
- Electronic Online Forms for Preceptor Assessment (mid and final), and Student Exit Assessment (PAS)
- Enhanced Communications
- Clinical Experience: Refined Process, Better Organized, Easier with Least Effort

Students



Students

- Experience Management
- Experience Placement
- Browse Associated Sites
- Documents Library
- Requirement Documents
- Online Student Assessment of the Experience (SAF), Student and Preceptor Performance (PAS, SACI)

"Most Efficient"

Acadaware Support Staff is Dedicated and Devoted to Your Success

To date, Acadaware has developed the following disciplines:

Physical Therapy, Physical Therapy Assistant, Occupational Therapy, Occupational Therapy Assistant, Orthopedic Physician's Assistant, Athletic Trainer, Nursing, Speech Therapy, Health Science, Nutrition Therapy, Clinical Education Science, Respiratory Therapist, SURG Tech, and Medical Administration, Preceptor, Clerkship, BA/MD, Physician Assistant.



acadaware

525 N. Cleve-Mass Rd., Suite 108, Akron, OH 44333
866-957-3937 info@acadaware.com



www.rehabessentials.com



We are a unique community of clinical scholars

Recognized as national and international experts, we are committed to delivering sustainable e-learning excellence that connects faculty, students, and professionals to the information that drives current best practice.



We exist to create powerful change in the delivery of health & health education

We deliver accessibility to the highest quality content; promote collaboration and networking; maximize communication and interchange; and provide anytime/anywhere on-line access in order to reduce variability and increase consistency of professional and post-professional education foundational to ensuring best practices.



We provide high quality, low cost, accessible education

We engage, support, and provide solutions for faculty, students, and health professionals who are educators, providers, and business and community leaders.

World-Class Faculty



Innovative Solutions



Custom Bundling

*Screening for Medical Disorders
Pharmacology in Rehabilitation
Medical Imaging in Rehabilitation*



*Critical Assessment of the Literature
Therapeutic Modalities
Pain Management*



*Wellness and Health Promotion
Business and Marketing
Legal and Ethical Considerations*



Applied Learning

*40 Participating Entry-Level Programs
Foundational Lectures support case based, high impact experiential learning*

Learn more about our solutions, successes,
and satisfied clients at
www.rehabessentials.com

DAILY PROGRAMMING

THURSDAY, OCTOBER 12

8:00 am–5:00 pm	ACAPT Board Meeting (Madison)
1:00 pm–5:00 pm	National Consortium of Clinical Educators Regional Consortia Leadership Meeting (Marion)
3:00 pm–7:00 pm	Education Section Board Meeting (Knox)
4:30 pm–8:00 pm	Registration Open (Regency Ballroom South Foyer)
5:30 pm–7:30 pm	CAPTE 40th Anniversary Reception (Union D)
6:00 pm–9:00 pm	ACAPT Open Forum: Hot Topics in PT Education and Leadership (Regency Ballroom)

FRIDAY, OCTOBER 13

7:00 am–5:00 pm	Registration Open (Regency Ballroom South Foyer)
7:00 am–8:00 am	Breakfast with Exhibitors (Union ABC)
8:00 am–10:00 am	Key Note Address (Regency Ballroom) Disruptive Innovation in Physical Therapy Education: Why a Shift in Focus is Essential to Add Value to the Emerging Health Care System? Speaker: Shafik Dharamsi, PhD Responses to Keynote Address: Ignite Session #1: Faculty Perspective Speaker: Cheryl Resnik, PT, DPT, FNAP, FAPTA, Associate Chair, Associate Professor, University of Southern California Ignite Session #2: Administrative Perspective Speaker: Dr. Susan Smith, Interim Dean, Drexel University Ignite Session #3: Clinician Educator Perspective: Samantha Zimmerman, PT, DPT, Center Coordinator of Clinical Education, Reeves Rehabilitation Center of University Health System Ignite Session #4: Words of Wisdom. Honoree's Perspective: Geneva R Johnson PT, PhD
10:00 am–10:30 am	Break with Exhibitors (Union ABC) POSTERS (Union Foyer) See page 32.

DAILY PROGRAMMING

10:30 am–12:00 pm

GRJ Forum On Innovation: Why, How and What Can We Do to Foster Disruptive Innovation to ADD VALUE in Our Educational Enterprises? (Regency Ballroom)

Speakers: Barb Tschoepe, PT, DPT, PhD; Caroline Goulet, PT, PhD; Carol Davis, PT

PTA Bachelor of Science Degree – Development and Assessment Case Report (Delaware AB)

Speakers: Erin Faraclas, PT, DPT, MSCS; Rhodri Purcell, MPT, OCS, CSCS; Susan Cotterman, PT, MBA

Matching Students to Clinical Sites: Best Practice or Practice in Futility? (Delaware CD)

Speakers: Carrie Foeller, PT, DScPT, CEEAA; Eric S. Stewart, PT, DPT; Karla A. Bell, PT, DPT, OCS, GCS; Ellen Wruble Hakim, PT, DScPT, MS, CWS, FACCWS

Inter-University Exploration of the Collaborative Model in Physical Therapy Clinical Education: The Impact on the Clinical Instructor Experience (Franklin CD)

Speakers: Alice M. Davis, PT, DPT; Shelene Thomas, PT, DPT, EdD, GCS; Katherine Myers PT, DPT; Catherine Bilyeu, PT, DPT, OCS

Simulation on the Cheap! Creating an Economical, Efficient and Effective Scenario – Based Patient Simulation Lab (Fairfield)

Speakers: Harshavardhan Deoghare, PhD, PT; Janet Konecne, PT, DPT, OCS, CSCS; Grant Hirayama, PT, DPT; Steven G. Snyder, PT, DPT, CSCS; Denise (Dee) Schilling, PT, PhD; Lindsey Liggan, PT, DPT, WCS, PRPC

Setting Them up for Success: Using Diverse Interprofessional Curricular Experiences to Prepare Students for Interprofessional Practice During Clinical Internships. (Union DE)

Speakers: Karen L. Gordes, PhD, PT, DScPT; Sandy M. Waller, PT, PhD, NCS; Laurie Neely, PT, DPT, NCS

Begin at the Beginning: A Coordinated Program of Integrated Clinical Experiences, Clinical Stimulations, and Full-time Clinical Internships (Knox)

Speakers: Jason Rucker, PT, PhD; Stacia Troshynski Brown, PT, DPT; Mildred Oligbo, PT, DPT; Yvonne Colgrove, PT, PhD

Making the Case for Holistic Admissions: Perspectives from Dentistry (ADEA), Medicine (AAMC), and Nursing- (AACN) (Marion)

Speakers: Carolyn L. Booker, Rh.D; Varnell P. Dewitty, Sarah Conrad, Steven Chesbro PT, DPT, EdD

DAILY PROGRAMMING

PLATFORM SESSION #1: (Morrow)

CSM: The Student Experience

Speakers: Lori M. Bordenave, PT, DPT, PhD; Tawna Wilkinson, PT, DPT, PhD

Physical Therapy Students' Search Patterns of PT-Now for Evidence-based Practice Resources: View of an Academic Year

Speakers: E. A. Reicherter, PT, DPT, PhD; Janette Scardillo, Hilary Greenberger, PT, PhD

Views of SOWH Members on the Role of Students in Pelvic Health Clinical Experiences: A Preliminary Report from the SOWH Clinical Education Task Force

Speakers: Lydia Thurston, PT, DSc, ATC; Audra Zastrow; Krista Ferguson Van Der Laan, Laurie Kilmartin; Sara Richardson

Transforming Physical Therapy Education Through the Use of Social Network Analysis

Speakers: Betsy J. Becker, DPT, CLT-LAN.; Sara Bills, DPT

12:30 pm–1:30 pm

Attendees Lunch on Own – Exhibits Open
(Union ABC)

1:30 pm–3:00 pm

ACAPT Business Meeting (Regency Ballroom)

PTA Educators SIG (Delaware AB)

Translating Interprofessional Education to Interprofessional Practice: Creating a Culture of Team-Based Care (Delaware CD)

Speakers: Michelle Gorman, Pt, DPT, GCS; Carly F Pick, PT, DPT; Naomi Price-Miller, PT; Laurie Neely, PT, DPT, NCS

The Reflective Clinician: Specific Reflection Techniques to Enhance Student Learning in the Clinical Setting (Franklin CD)

Speaker: Lisa Giallonardo, PT, MS, OCS

We Won't Be Silos Anymore! How a Mult-Patient Interprofessional Simulation is Designed to Change Practice (Fairfield)

Speakers: Erin M. Thomas, PT, DPT; Georgianna Sergakis, PhD, RRT, FAARC; Lisa Rohrig, BSN, RN; Marcia Nahikian-Nelms, PhD, RDN, LD, FAND; Julie Legg, PTA ; Carolyn MCClerking, DNP, ACNP-BC; Beth Wagner Liston, MD, PhD, FACP; Janice Wilcox, DNP, RN, CNL; Christin Ray, PhD, CCC-SLP; Jill E. Clutter, Lisa Raiz, MSW, PhD

Implementing Exercise is Medicine into Physical Therapy Curricula (Union DE)

Speakers: Shawn M. Drake, PT, PhD; Marilyn Moffat, PT, DPT, PhD, DSc, GCS, CSCS, CEEA, FAPTA

DAILY PROGRAMMING

1:30 pm–3:00 pm

**Walking the Talk: Student – Run Pro Bono
Fostering Leadership and Advocacy Skills in
the Next Generation of Physical Therapist (Knox)**

Speakers: Robin L. Dole, PT, DPT, EdD, PCS; Ellen A. Erdman, PT, DPTD, HPCS; Martha Schiller, PT, DPT, MSA; Anne Kloos, PT, PhD, NCS; Marka G. Salsberry, PT, DPT; Jill D. Black, PT, DPT, EdD

**But Can You Improvise? : Using Improvisation
Exercises to Develop and Remediate Communication
and Problem Solving Skills in Physical Therapy
Students (Marion)**

Speaker: Janet Konecne, PT, DPT, OCS, CSCS

Unleashing the Power of “E”

Ignite Session #2: Faculty Perspective (Morrow)

Speakers: Jennifer E. Green – Wilson, PT, MBA, EdD; Barbara A. Tschoepe, PT, DPT, PhD; Diane Clark, PT, DSc, MBA

3:00 pm–3:30 pm

Break with Exhibitors (Union ABC)

POSTERS (Union Foyer) See page 32.

3:30 pm–5:00 pm

**ACAPT Business Meeting (Motions Discussions)
Continued... (Regency Ballroom)**

**Student Readiness: Working with the Challenging or
Exceptional Student (Delaware AB)**

Speakers: Carla F. Huggins, PT, DPT ; Tracy A. Wright, PT, DPT, GCS

**Train the Trainer: Developing Directors of Clinical
Education and Clinical Instructors as Interprofessional
Collaboration Champions (Delaware CD)**

Speakers: Amber Fitzsimmons, PT, DPTSc; Beth P. Davis, PT, DPT, MBA; Stephen Jernigan, PT, PhD; Holly Wise, PT, PhD

**Affective Domain Development: Incorporating Empow-
erment Education Principles and Activities (Franklin CD)**

Speakers: Karen L Sawyer, PT, DPT, MA; Janet Readinger, PT, DPT; Susan S. Tomlinson, PT, DPT; Chritina Kocol

**Integrating IV STEP Pearls into Entry-Level Education
(Fairfield)**

Speakers: Genevieve Zipp, PT, EdD; Jane Sullivan, PT, DHS, MS; Nancy Fell, PT, PhD, NCS; Deborah Larsen, PT, PhD, FAPTA; John Buford, PT, PhD ; Sally Westcott, PT, PhD; Kristie Bjornson, PT, PhD; Ann VanSant, PT, PhD

**Music, Dance, Evidence, Education. Getting Students
and Older Adults Moving in the “Key of G” (Union DE)**

Speaker: Christine Childers, PT, MS

**Integrating Narrative Stories into Evidence-Based
Case Study Frameworks: Blending Art and Science
in Physical Therapy Education (Knox)**

Speaker: Amy Both, PT, MHS

DAILY PROGRAMMING

3:30 pm–5:00 pm

The 2:1 Model of Clinical Education: Debunking Myths with Data (Marion)

Speakers: Eric S. Sterart, PT, DPT; Kristy Recek, PT, MPT; Carly F Pick, PT, DPT; Michele Uhler, PT; Ellen Wruble Hakim, PT, DScPT, MS, CWS, FACCWS

Questions that Work: The Key to Cultivating Student Success in the Clinic (Morrow)

Speakers: Marisa C. Birkmeier, PT, DPT, PCS; Margaret Plack, PT, DPT, EdD

5:00 pm–6:30 pm

Clinical Education SIG (Delaware AB)

Clinical Reasoning Curricular & Assessment Consortium (Delaware CD)

Research Intensive PT Programs Consortium (Franklin CD)

Education and Pedagogy Consortium (Fairfield)

Early Assurance BS/DPT Program Consortium (Union DE)

Education Section Anatomy SIG (Marion)

6:30 pm–8:00 pm

Reception w/ Exhibitors (Union ABC)

SATURDAY, OCTOBER 14

7:00 am–5:00 pm

Registration Open (Regency Ballroom South Foyer)

7:00 am–8:00 am

Breakfast with Exhibitors (Union ABC)

7:00 am–9:00 am

ELI Networking Breakfast (Peppercorn) *Private Event

8:00 am–10:00 am

National InterProfessional Education Consortium Meeting (Morrow)

Residency & Fellowship Educators SIG (Delaware AB)

Humanities, Ethics, and Professionalism Consortium (Delaware CD)

Academic Faculty SIG (Franklin CD)

Scholarship of Education SIG (Fairfield)

New Administrators Workshop (Marion)

Speaker: Barb Sanders, PT, PhD, FAPTA; ; Nancy B. Reese, PT, PhD

National Consortium of Clinical Educators Consortium Meeting (Regency Ballroom)

Habits of Self-Transforming Leaders: Continuing the Conversation (Union DE)

Speakers: Janet Bezner, PT, DPT, PhD, FAPTA; Tony English, PT; Nan Hyland, PT, PhD; Stephanie Kelly, PT; Barbara A. Tschope, PT, DPT, PhD; Lisa VanHoose, PT; Thom Werner, PT, PhD

DAILY PROGRAMMING

10:00 am–10:30 am

AM Break with Exhibitors (Union ABC)

POSTERS (Union Foyer) See page 32.

10:30 am–12:00 pm

CAPTE/FSBPT Forum (Regency Ballroom)

It Takes a Village: Tiered Mentorship for Development of URM in PT (Delaware AB)

Speakers: Vanetta K. Kennedy, PT, DPT; Mya Shackelford,

Assessment to Support Program Quality and Development: An ACAPT Initiative to Foster Educational Excellence through Benchmarking (Delaware CD)

Speakers: Barb Tschoepe, PT, DPT, PhD; Peter Altenberger; Amy E. Heath, PT, DPT, PhD, OCS; Kimberly Topp, PT, PhD, FAA; Dee Schilling, PT, PhD; Jacklyn Brechter, PT, PhD; Diane Jette, PT, DPT, DSc, FAPTA

Aligning Entry-Level DPT Acute Care Curriculum with Core Competencies and Evidence (Franklin CD)

Speakers: Linda B. Horn, PT, DScPT, MHS, GCS, NCS; Laurie Neely, PT, DPT, NCS

Mental Health and the DPT Student: Retention Strategies for Successful Outcomes (Fairfield)

Speakers: Jennifer B. Ellison, PT, PhD; Peggy B. Gleeson, PT, PhD; Colleen Gleeson, MA, LPC-1

Pathways to the PhD: The Future of the Academy (Union DE)

Speakers: John A. Buford, PT, PhD; Deborah L. Givens, PT, DPT, PhD; Julius DeWald, PT, DPT; James Gordon, PT, EdD, FAPTA

Raising the Bar - Empowering Students to Provide Altruistic and Compassionate Care in a Pro-Bono, Neuromuscular, Mentored Integrated Clinical Experience. (Knox)

Speakers: Gail Stern, PT, PhD, NCS; Tara Maroney, PT, DPT, CEEAA, GCS; Diane O'Sullivan, PT, DPT

PLATFORM #2 (Marion)

Developing Reflective Thinking to Enhance Clinical Problem Solving

Speakers: Stacy Sekely; Pamela Pologruto

More than Employment and Pass Rates: PTA Professional Development through Assessment and Academic Program and Workforce Partnerships

Speakers: Christina D. Howard, MPT; Case Russ, PT, OCS, COMT, FAAOMPT; Pam Kikillus, PT, DSc, OCS, COMT, FAAOMPT, CHT; Heather Chavin, MA

DAILY PROGRAMMING

10:30 am–12:00 pm

Using Behavioral Messaging to Bridge the Gap Between the Academic and Clinical Environments Building Resilience: Utilizing mindful meditation in a lived experience aiming at health behavior change

Speaker: Cori Arquines, BS, PT, BA Psychology

PLATFORM #3 (Morrow)

A Dissemination of Current and Future Use of The Core Competencies of Entry-Level Practice in Acute Care Physical Therapy

Speakers: Kristina Greenwood, PT, DPT, MS, GCS; Melissa Hake, DScPT; Erin Milton, PT, DPT; Lauren Mitchell, PT, DPT; Babette Sanders, PT, DPT, MS, FAPTA

Exploring Factors that Lead to Increased Preparedness among DPT Students for Acute Care Clinical Placements

Speakers: Kristin Greenwood, PT, DPT, MS, GCS; Anson Rosenfeldt, PT, DPT, NCS, MBA; Karoline Lubbeck, PT, DPT; Jennifer Brown, MS, PT; Maura Iverson, PT, DPT, SD, MPH, FNAP, FAPTA

Implementation of a Hospital-based Orthopaedic Physical Therapy Residency Program; Clinical Outcomes and Perceived Benefits

Speaker: John J. Winslow, DPT

Leadership Styles of Clinical Coordinators in Physical Therapy Clinical Education: How Their Style Affect Leadership Outcomes

Speaker: Allison Kellish

12:00 pm–1:15 pm

Attendees Lunch on Own – Exhibits Open
(Union ABC)

1:15 pm–2:45 pm

Policy Map: Digital Humanities Tool Linking Research and Practice in Physical Therapy Education (Regency Ballroom)

Speakers: Catherine Maher, PT, DPT, GCS; Genevieve Zipp, PT, EdD

The Four Horsemen of the Apocalypse: The Critical Challenges and Opportunities in Physical Therapy Education and Research (Delaware AB)

Speakers: Gail Jensen, PhD, PT, FAPTA; Laurita Hack, DPT, PhD, MBA, FAPTA; Terrence Nordstrom, PT, EdD, FAPTA; Diane Jette, PT, DPT, DSc, FAPTA; Rebecca Craik, PT, PhD; Sharon Dunn, PT, PhD, OCS; Bill Boissonnault, PT, DHSc, FAPTA

Hitting the Academic Jackpot with One Interprofessional Community Activity (Delaware CD)

Speakers: David M. Morris, PT, DHSc, FAPTA; Donald Lein, PT, PhD; Tara Pearce, PT, DHS

DAILY PROGRAMMING

1:15 pm–2:45 pm

If you Build It, They will Come: Advocacy in the Development of a Community Learning-Spaced Clinic in a PTA Program (Franklin CD)

Speakers: Suzanne Reese, PT, DPT, MS

Interprofessional Education and Clinical Reasoning for Clinical Instructors: What, Why, and How (Fairfield)

Speakers: Myla U. Quiben, PT, PhD, DPT, MS, GCS, NCS; Brandy Schwarz, PT, DPT

The Jar of Truthiness: Developing Leaders with Integrity (Knox)

Speakers: Nathan Brown, PT, DPT, GCS, CSCS; Amanda Lalonde, PT, DPT, GCS; Sarah E. Luna, PT, DPT, GCS

PLATFORM SESSION #4 (Marion)

Facilitating Student Clinical Development through In-Class Patient Experiences: Implementation of a Neuro Clinic

Speakers: Rosanne Thomas, PT, PhD; Jamie Bayliss

An Artist in Residence Program to Support Health Professions and Creative Arts Education

Speakers: Mary Pike, PT, PhD; Mark R. Wiegand, PhD

ICE Performance Assessment: A Tool to Enhance DPT Clinical Professional Skill Development

Speaker: Sara North, DPT

Development of Performance Benchmarks to Standardize a Clinical Education Curriculum

Speakers: Rosanne Thomas, PT, PhD; Jamie Bayliss

PLATFORM SESSION #5 (Morrow)

Establishing our Brand for Today's Applicant – a DPT Interview Process

Speakers: Cheryl Footer, PT, PhD; Cameron W. MacDonald, PT, DPT; Andrew C. Smith, PT, DPT, PhD; Marcia B. Smith, PT, DPT, EdD, NCS

Leadership in Physical Therapist Education: Where are we Now and Where Should we be Going?

Speaker: Elizabeth Clark, PT, DPT, EdD, NCS

Developing a Robust Curriculum in a New DPT Program Using Digital Tools and Benchmarks - A Case Study

Speakers: Cynthia K. Scott; Boon Ong, DPT, NCS; Carroll Brown, DPT, OCS; Amy Parker, DPT, OCS

Analyzing and Mapping the Entry-Level Doctor of Physical Therapy Curriculum

Speakers: Joyce R. Maring, PT, DPT, EdD; Marisa C. Birkmeier, PT, DPT, PCS; Aarti Vaishnav, MS, MBS; Ellen Costello, PT, PhD

DAILY PROGRAMMING

3:00 pm–4:30 pm

Sustaining a Culture of Assessment: An Ongoing Systematic Analysis of Outcomes and Benchmarks as Part of Curricular Assessment and Planning

(Regency Ballroom)

Speakers: Sandy M. Waller,; Laurie Neely, PT, DPT, NCS; Linda Horn, PT, DScPT, MHS

10 Tips for Mid-Career Professional Development

(Delaware AB)

Speakers: Karen Huhn, PT, PhD; Patricia Kluding, PT, PhD; Patricia McGinnis, PT, PhD; Teresa Miller, PT, PhD; Susan Wainwright, PT, PhD

Historical Evolution and Impact of Non-Cognitive Assessment in Physical Therapy Admissions

(Delaware CD)

Speakers: Patrick Pabian, PT, DPT, SCS, OCS, CSCS; Samantha Moya, M. Ed.; Nicole Dawson, PT, PhD, GCS,; James Sonne, PhD; Erin Brown, PT, DPT, NCS

Transforming Physical Therapist Clinical Education for 21st Century Practice: Findings of the APTA Best Practice in Clinical Education Task Force

(Franklin CD)

Speakers: Kathleen Mairella, Lisa B, Johnston, PT, MS, DPT; William McGehee, PT, PhD; Christopher Meachem, PT, DPT; Colette Pientok, PT, DPT, OCS; MaryJane Rapport, PT, DPT, PhD, FAPTA; Robert Rowe, PT, DPT, DMT, MHS

Value in Kind: Creating a Leadership Win

(Fairfield)

Speakers: Sharon Kurfuerst, EdD, OTR/L, FACHE, FAOTA, FABC; Eric S. Stewart, PT, DPT; Albert Mears; Ellen Wruble Hakim, PT, DScPT, MS, CWS, FACCWS

The Consortium for Humanities Ethics and Professionalism Invited Presentation: The Invisible Elephant Project

(Union DE)

Speakers: Marina Tsaplina; Jennifer D. Hastings, PT, PhD, NCS

Holistic Admissions in Action: Case Examples from Dentistry and Medicine

(Knox)

Speakers: Jack Dillenberg,PT; Andria Williams,PT; Michael de Arellano,PT; Steven Chesbro,PT

PLATFORM SESSION #6:

(Marion)

Practicality of Interprofessional Education: Championing Change

Speakers: Jamie Bayliss; Rosanne Thomas, PT, PhD

Successful Implementation of an Interprofessional, Experiential-learning Elective Course for Pre-health Professional, University Students in Collaboration with a Community Partner: The What, Why's and How's

Speakers: Madalynn T. Wendland, DPT; Kelle DeBoth, PhD, OTR/L

DAILY PROGRAMMING

3:00 pm–4:30 pm

Perception vs. Reality: Interprofessional Education (IPE) and Interprofessional Collaborative Practice (IPCP) in Clinical Internships

Interprofessional Wellness Program within a Student-run PT Clinic with Pharmacy and Social Work

Speakers: Brandy Schwarz, PT, DPT, MOT, MBA; Amber Thurston, SPT; Kirstein Womack, SPT

PLATFORM SESSION #7: (Morrow)

Development and Initial Success of a Holistic DPT Admissions Process

Speakers: John A. Buford, PT, PhD; Ajit M. Chaudhari, PhD, OCS

Demographic and Admission Predictors of Students Who Had Difficulty in Entry Level DPT Programs

Speakers: Amy Heathm PT, DPT, PhD; Stacy Fritz, Ed Mahoney, Teresa Brown, Addie Middleton

Looking Beyond GPA and GRE: Admission Strategies in a 2-year Blended Learning DPT Program

Speaker: Michael T. Jones, PT, PhD, MHS, OCS, MTC

The “Softer Side” of the Admissions Process- Past, Present and Future

Speakers: Amy Hadden, PT, DPT, OCS, MTC; Robert S. Phillips; Mark Wilhelm

4:30 pm–5:00 pm

PM Break with Exhibitors (Union ABC)

POSTERS (Union Foyer) See page 32.

5:00 pm–6:00 pm

Oxford Debate (Regency Ballroom)

7:00 pm–11:00 pm

25th Anniversary Celebration of Diversity dinner: Physical Therapy Scholarship for a Diverse Future (Franklin Park Conservatory and Botanical Gardens)

Buses will be leaving from East Connector at 6:45PM and will run every 15 minutes. The last bus will leave Franklin Park Conservatory at 11:15PM.

SUNDAY, OCTOBER 15

6:30 am–8:00 am

DPT Terminal Internship Consortium (Regency Ballroom)

7:00 am–12:00 pm

Registration Opens (Regency Ballroom South)

7:30 am–8:30 pm

Networking Breakfast for Attendees (Delaware Foyer)

8:30 am–10:00 am

Positive Peer Pressure and Peer Mentoring for Physical Therapy Faculty (Regency Ballroom)

Speakers: Patricia Kluding, PT, PhD; Catherine Siengsukon, PT, PhD; Susan Waingwrite

DAILY PROGRAMMING

8:30 am–10:00 am

Rethinking Admissions: Impact of Disability Rights / ADA (Delaware AB)

Speakers: Ellen Wruble Hakim, PT, DScPT, MS, CWS, FACCWS; Anne Jannarone, MS; Jennifer Becnel – Guzzo.; Carrie Foeller, PT, DScPT, CEEAA

Behind the Curtain: Enhancing Clinical Reasoning through Effective Clinical Mentoring in Acute Care Practice (Delaware CD)

Speakers: Sharon L. Gorman, PT, MS, DPTSc; Erin M. Thomas, PT, DPT; Tonya Apke, PT, DPT, OCS; Christopher Maurer PT, DPT

How Fast Are You Running to ‘Keep in the Same Place’? Using Evidence-Based Learning Strategies to Free PT and PTA Curricula from the ‘Red Queen’s Trap’ (Franklin CD)

Speakers: Eliza Zuber, PT, PHD; Jeannne Smith, PT, DPT, MPA, OCS; Amy Garrigues, PT, DPT, OCS, FAAOMPT

Catalysts for and detractors from interprofessional learning during physical therapy internships (Fairfield)

Speakers: Shelene Thomas, PT, DPT, EdD, GCS

Making causal inferences an explicit when reasoning: Implications for physical therapy practice, research and education (Union DE)

Speakers: Sean M. Collins, PT, ScD; Kelly Legacy

Facilitating Interprofessional Education through the Lens of Health Humanities. (Knox)

Speakers: Sarah Blanton, PT, DPT, NCS; Nancy R. Kirsch, PT, DPT, PhD, FAPTA; Bruce Greenfield, PT, PhD; Emma Goldberg, PT; Zohar Kapasi, PT, DPT, MBA; Gail Jensen, PT, PhD, FAPTA

PLATFORM SESSION #8 (Morrow)

Required International Service Learning Practicum: A Model for Improving Cultural Awareness and Clinical Skills in Physical Therapy Students

Speakers: Gerry D. Ezell, MD; Michael McGalliard, PT, ScD

Pathways to Graduate School Success - An Interprofessional Orientation Focusing On Successful Transition to Graduate Professional Education

Speakers: Rosanne Thomas, PT, PhD; Jamie Bayliss

Reporting and Barriers to Reporting among Doctor of Physical Therapy (DPT) Student Interns before and after an Applied Ethics Course

Speakers: William L. Scorr, MSPT; Caryn Pierce, DScPT(c)

DAILY PROGRAMMING

10:15 am–11:45 am

Transforming Students to Become the Next Generation of Leaders and Advocates in Physical Therapy: A Multifaceted Approach.

Speakers: Aliya Chaudry; Joy Karges; Elizabeth Beasley, PT, PCS; Amanda J. Adomson, PT, DPT, OCS

Using the Visual Arts to Stimulate Reflection and Growth in Physical Therapy Students

(Regency Ballroom)

Speakers: Karen McIntyre, PT, DPT; Jane Keehan, PT, PhD, OCS

Epic Fails, Lessons Learned And Strategies for the CCCE (Parts I and II) (Delaware AB)

Speakers: Vicki LaFay PT, DPT, CSCS, CEEAA; Mary Ellen Dougherty, MSPT, ATC; Jill Dungey, PT, DPT, MS, GCS; Pragati Duttaroy, PT; Megan Freeland, PT, DPT, PCS; Nicki Silberman, PT; Angela Stolfi, PT

The Use of Technology in PT/PTA Education

(Delaware CD)

Speakers: Robert S. Phillips, PT, DPT, PhD, NCS; Amy Hassen, PT, DPT, OCS, MTC

Interprofessional Education Collaboration Beyond Rehabilitation Medicine: The How to of Planning For Success Utilizing an Ipe Simulated Emergency as a Case Example. (Franklin CD)

Speakers: Angela MacCabe, PT, DPT; Barbara Stolle; Melissa Castillo; Nichole Higgins; Kari Potter; Alycia Brantz

EDGE-ucation 2.0: Moving Forward the Value of Physical Therapy (Fairfield)

Speakers: Marghuretta D. Bland, PT, DPT, NCS; Dorian Rose, PT, PhD; Genevieve Zipp, PT, EdD; Nancy Byl, PT, PhD, MPH, FAPTA; Carmen Capo-Lugo, PT, PhD; Heather Dillon-Anderson; Michele Sulwer, PT, DPT, NCS; Rie Yoshida, PT, NCS

Using FSBPT Tools and Reports for Curriculum Development and Student Remediation for the NPTE

(Union DE)

Speakers: Lorin Mueller; Thomas Mohr; Richard Woolf PT, DPT, CSCS; Jeanne Cook PT, PhD

Mentoring through Networking: An Innovative and Participatory Model of Empowering Clinical Educators to Advance Student Clinical Reasoning (Knox)

Speakers: Tonya Apke, PT, DPT, OCS; Janice Howman, PT, DPT; Brianne Rice, PT; Amelia Siles, DPT, NCS; Sean Gallivan, PT, MS, C/NDT, NCS; Erin M. Thomas, PT, DPT

DAILY PROGRAMMING

10:15 am–11:45 am

PLATFORM SESSION #9: (Morrow)

The Use of the Clinical Internship Evaluation Tool on the Exxat STEPS System for All Levels of Clinical Internships

Speakers: Lynn M. Fitzgerald; Aarti Vaishnav, MS, MBA; Jennifer Thomas, MS

The Impact of Changes to Clinical Experience and Didactic Sequencing On Clinical Education Outcomes of Doctor Of Physical Therapy Students

Speaker: Ann M. Williamson, DPT

Clinical Credentialing – A Strategy to Identify and Track Student Readiness to Enter into Clinical Education

Speakers: Halle Zeleznik; Lynn M. Fitzgerald; Kathleen Kelly, PhD, PT

What Predicts Graduation Success from a Physical Therapy Education Program?

Speakers: Gretchen Roman, PT, DPT, OCS; Matthew P. Buman, PhD

11:45 am

Conference Concludes



Educate smarter

Education Management Solutions for PT Programs

Exxat's education management platform helps PT schools save time, increase efficiency and improve educational outcomes.

See why schools like George Washington and Northwestern partner with us to manage clinical education, curriculum mapping and more.

Over 150 programs use Exxat to:

- Manage clinical education
- Map & track curriculum and didactic outcomes to standards and goals
- Oversee contracts throughout the lifecycle
- Handle all aspects of student compliance
- Solve administrative challenges
- Manage accreditation requirements

Key Features

- Ultimate Database
- Student Portal
- Built-in Communication
- Integrated Slot Requests
- Optimized Placements
- Comprehensive Reports
- Curriculum Mapping
- Amazing Customer Service



info@exxat.com

www.exxat.com

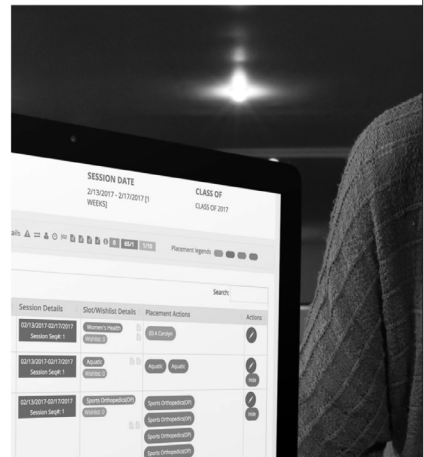

"I am impressed with Exxat's knowledge of physical therapy and appreciate that they have been able to customize our system to meet our needs. . . I couldn't imagine managing clinical education without it!"

Dalerie Lieberz, College of St. Scholastica



A Leadership Development Model Connecting Education and Clinical Environments

Presenters: Heidi Eigsti, PT, DPT, PhD; Alice M. Davis, DPT

Are Changes in Clinical Education Necessary? – Clinicians' Perspective

Presenters: Lori Madiara, PT, DPT; Jared Barilla, Mark Fuse, Alexa Nisiotis

"Flipping" for Clinical Reasoning: The Link between the Classroom and the Clinic

Presenters: Lauren Snowden; Genevieve Zipp, EdD; Catherine Maher, PT, PhD; Christine Schaub

A Collaborative Model of Integrated Clinical Education in Physical Therapist Education: Application to the Pediatric Essential Core Competency of Family-Centered Care

Presenters: Kara Lardinois, PT, DPT, C/ND; Kyle Covington, DPT, PhD; Dora Gosselin, PT, DPT, PCS; Dana McCarthy, PT, DPT, PCS; Kathleen Ollendick, PT, DPT, PCS

Students' Perceptions of Cultural Challenges Based on Discussion Board Responses: What Can We Learn?

Presenters: Janelle K. O'Connell, PT, PhD, DPT; Mary Lou Garrett, DPT; Amber Shook; Celeste S. Burkett; Talor D. Lunsford; Robert L. Ramos

Academic and Clinical Faculty Partnerships for Clinical Education Program Enhancements

Presenters: Linda M. Hall, PT, MS, DPT; Jennifer Dickson

Facilitating Reflection during an International Clinical Education Experience in South Africa: A Case Study

Presenter: Debra Bangs, PT, DPT

Leading and Learning Through an Interprofessional Global Health Pathway

Presenters: Nancy F. Mulligan, PT, DPT, OCS; Wendy Anemaet, PT, DPT, PhD; James Nash, MPH, PhD; Teresa Christensen, PhD; Matthew Fete, PhD; Ann Gallaway, RN, PhD; Sara Jarrett, EdD, MS, CNS, RN; Cheryl Schwartz, MA

Does the GRE Satisfy the Critical Thinking Objective in Physical Therapy Education Admissions?

Presenter: Emily Shannon Hughes, PT

The Art of Chronic Pain: Using Medical Humanities to Reduce Implicit Bias & Cultivate Empathy in Physical Therapy Students

Presenters: Jennifer C. Kish, PT, DPT; Nathan Brown, PT, DPT; Sarah E. Luna, PT, DPT

Effect of Repeating Undergraduate Prerequisite Courses on the Academic Performance in Doctor of Physical Therapy Program

Presenters: Richard C. Clark, PT, DSc, SCS; Yi-Po Chiu, PT, PhD

Comparison of a Novel Immediate Feedback Tool vs. Scantron on Student Retention of Knowledge: A Pilot Study

Presenters: Jennifer Dickson; Kristinia Reid; Elizabeth Nowinski; Rachel McDonald; Lana Spomer

Patient Perceptions Regarding Quality of Care and the Patient Experience in a Student-Led Pro-Bono Clinic

Presenter: Jody Eckert

StoryCorps Rehab: Using oral narratives to foster engaged listening in the clinic and classroom

Presenters: Sarah Blanton, DPT; Donna Smith, DPT, NCS, GCS; Emma Goldberg, SPT

Geriatric Outreach and Training with Care (GOT Care!): An Innovative Interprofessional Clinical Training Project

Presenter: Susan S. Glenney, PT, DPT, GCS, CEEAA

Interprofessional Education in Action: Use of the IPEC Core Competencies in a Community Falls Clinic

Presenters: Christine Lysaght, PT, DPT; Jennifer Radloff; Stokes Kim; Young Kim

Preparing Students to Work Collaboratively in an Acute Care Environment through an Interprofessional Simulation Experience.

Presenters: Chad Lairamore, PT, PhD, GCS, NCS, FNAP; Clint Reed, PhD, RN, CN; Veronica Rowe, PhD, OTRL/O

A Lasting Impression: Incorporating Authentic Learning Experiences to Improve Clinic-Related Performance and Self-Efficacy

Presenters: Ellen Costello, PT, PhD; Elizabeth Ruckett, PhD, PT, DPT, NCS; Susan Leach, PT, PhD, NCS, CEEA; Joyce R. Maring, PT, DPT, EdD

Development of an Integrated Clinical Experience Combining a Spanish Course and Pro-Bono Clinic Participation for Physical Therapy Students

Presenters: Elsa Drevyn; Neva Kirk-Sanchez; Teresa Glynn, PT, DPT; Johanna Segura

Beyond PICO, CAT Walks, and Journal Clubs, Cinematography Connects Students to EBP

Presenters: Susan G. Klappa, PT, PhD; Eric Strong, PT, MS, PhD, CEEAA; Brian Wienk, PT, ScD, MS, COMT; Matt Dewald, PT, ScD, MS, COMT; Heidi M. Nelson; Patrick Hauer, PT, EdD, MHS; Jason Adams, PhD, MS, DC, Patrick Cross, PT, DPT, RHF; Meggen Lloyd

Does Method of Instruction Impact Entry-level DPT Students' Orthopaedic Competency?

Presenter: Antoinette Spector, DPT, OCS

Clinical Decision-Making in DPT Graduates Completing a Year-long Terminal Internship Compared with DPT Graduates Who Do Not

Presenters: Kelly Macauley, PT, DPT, CCS, GCS; Tracy J. Brudvig, PhD; Keith Hallbourg

Enhancing PT/PTA Professional Relationships through Intraprofessional Collaboration

Presenters: Brad Profitt, PT, DPT, OCS, OCS, DC, CFCE; Neil Evans, PT, DPT, OCS, CSCS; Duane S. Davis, PT, EdD, OCS; Gretchen Pfost, PT, DPT, NCS; Travis Carlton, PTA, EdD, MS; Kelly Terry, DPT, MS, ATC; Ryan Walker, DPT

Will a Structured 6-week Module of Motivational Interviewing (MI) Improve the Level of Empathy in 2nd Year Physical Therapy Students?

Presenters: Phyllis Heyne- Lindholm, PT, DPT; Tara Haj, PT, DPT

Interprofessional Collaboration (IPC) Confidence Assessment of Doctor of Physical Therapist Students and Doctor of Nursing Practice Students Following an Interprofessional Phone Call Experience

Presenters: Karen Berg; Erica Sherman; Denise Cooper; Megan Keiser

Clinical Instructors' Perception of the Impact of the Problem Based Learning Pillars for Successful Clinical Education Experiences for Doctor of Physical Therapy Students

Presenters: Rhonda L. Haley; Krissy M. Grubler, PT, DPT; Kyle Connery; Cody Giles; David Heinitz

Is Grit a key factor in DPT program retention and success?

Presenters: Jennifer B. Ellison, PhD; Katy Mitchell, PT, PhD; Jennifer Bogardus; Peggy B. Gleeson, PT, PhD

Attitudes of Able-bodied Physical Therapists Towards Physical Therapists with Mobility Impairments

Speaker: James R. Brennan, PT, PhD

Student Perceptions of How Their Didactic Interprofessional Education (IPE) Influenced Their Interprofessional Collaborative (IPC) Clinical Experience Practice

Presenters: Pamela J. Reynolds, PT, EdD; Andrea Kessler

Is Peer-Evaluation Effective In The Classroom? Entry-Level Doctor of Physical Therapy Student Perspectives

Presenters: Dawn James, PT, DPT, PCS; Natalie Weeks – O'Neal, DPT; Teressa F. Brown, DPT, PhD, OCS; Jennifer Oh, SPT

Reading Comprehension as an Admissions Criteria in an Entry-Level Physical Therapist Education Program: Correlation between the Nelson Denny Reading Test and the GRE

Presenters: Amy Wilson, PT, MSd; Jennifer D. Hastings, PhD

International Educational Opportunities for Neurologic Residents

Presenters: Suzanna D. Okere, PhD; Steven Spivey, PT, DPT

Factors that Impact DPT Admission Yield Rate

Presenter: Scott A. Burns, PT, DPT, OCS

The Prediction of National Physical Therapy Examination First Time Pass Rates Using Reading Comprehension and Critical Thinking Skills Tests

Presenter: LaToya L. Green, PT, DPT

What do you Need to Succeed? Predictors for Improving Performance on the National Physical Therapy Examination

Presenters: Kerry C. Mallini, MPT, NCS; Anne Boddy, PhD, DPT; Lisa Nichols, PT, MHS; Matthew Daugherty, PhD, DPT, OTR/L



NEW FACULTY OPPORTUNITY

THE POSITION: Tenure-Track Assistant/Associate Professor

RESPONSIBILITIES: Teach Physical Therapy clinical coursework in the classroom, clinical, laboratory and on-line, advise students, conduct collaborative and independent research, mentor student research and engage in department, college, university and professional service.

THE PROGRAM: The DPT program at Indiana State University was admitted to candidacy status in April, 2015 and admitted its 3rd class in the summer of 2017.

- ∞ Reasonable teaching loads
- ∞ Support for faculty development
- ∞ Extensive community engagement
- ∞ Focus on professionalism
- ∞ Family-friendly environment
- ∞ New Building December 2017

Interesting parties are encouraged to contact the search committee chair, Howell Tapley at: howell.tapley@indstate.edu or call 812-237-4428. **Available at ELC for informal discussions.**

FIRST TIMER'S GUIDE TO ELC

For newcomers, this abbreviated history in addition to our Welcome Letter may help you to understand the roots of the Educational Leadership Conference and how the ELC is organized. Prior to the *ELC*, there were two separate conferences relevant to PT educators: 1) the *National Clinical Educators Conference*, convened biennially for clinical educators, and 2) the *Academic Administrator's Special Interest Group (AASIG)* of the APTA Education Section, held annually for physical therapy program administrators. From 2004-2005, a joint meeting was created called the *APTA Education Section Academic and Clinical Education Conference* to bring all stakeholders interested in PT education together at a single conference. In 2006, the name of the conference was changed to the *Educational Leadership Conference*.

During CSM 2011, a motion was brought to the Education Section Business Meeting to dissolve the AASIG from the Education Section; and in 2013, the APTA House of Delegates bylaws granted component status to the APTA-American Council of Academic Physical Therapy (ACAPT). ACAPT's membership now consists of **member institutions** representing CAPTE-accredited physical therapist programs. To learn more about the ACAPT mission, structure, function, activities, consortia, and leadership, go to <http://www.acapt.org>. Consortia descriptions are detailed in subsequent paragraphs.

The APTA Education Section is a membership organization for **individual members** and continues with six Special Interest Groups (SIGs): Academic Faculty (AFSIG), Clinical Education (CESIG), Physical Therapist Assistant Educators (PTASIG), and Residency/Fellowship Education (RFESIG) with the newest SIGs being the Scholarship of Education (SOESIG) and Anatomy Educators (AESIG). Individual membership fees apply; however, there is no cost incurred for SIG memberships. Descriptions of each SIG are in subsequent paragraphs. To learn more about the Education Section mission, structure, function, activities and leadership go to <http://aptaeducation.org/home-page.cfm>.

Thus, the intent of the ELC is to provide programming and activities that serve all leaders, clinicians, and educators interested in the pursuit of excellence in physical therapy education. The program includes scholarly, peer-reviewed posters and presentations pertinent to Physical Therapy educational administrators, faculty, directors of clinical education, clinical coordinators of clinical /residency education, and clinical instructors. Ample time is also provided for networking with exhibitors and colleagues during the breakfasts, exhibitor breaks, lunches, and the Friday evening exhibitor reception.

ACAPT CONSORTIUM DESCRIPTIONS

The Clinical Reasoning Curricula & Assessment Consortium will serve as a resource and forum for educators, both clinical and academic, interested in best practice for teaching and assessing clinical reasoning skills. Additionally, the group will work to develop a research plan relative to clinical reasoning and will conduct multi-institutional research projects to increase our understanding of the teaching and learning of clinical reasoning.

The Consortium for the Humanities, Ethics and Professionalism (CHEP) provides a forum for faculty with an interest and commitment to the critical role of the humanities in health professions education and the development of physical therapists who fully embrace a professional identity grounded in the profession's public serving purpose.

The DPT Terminal Internship Consortium provides a mechanism and venue for ongoing discussions related to standardizing and enhancing the terminal clinical education experience. As well, consortium members may serve as a resource for discussions related to implementation of extensive terminal clinical education experiences, which may include the yearlong internship model. The consortium also provides resources for those interested in pursuing establishment of an academic-clinical partnership.

The Early Assurance BS/DPT Program Consortium represents the faculty and admissions coordinators from Doctor of Physical Therapy (DPT) programs that incorporate an undergraduate course of study leading directly into the DPT degree. The purpose of this consortium is to share and collaborate on issues unique to Early Assurance programs in the areas of admissions, student outcomes, curricular design and development, faculty load and data collection to further both institutionally driven and academic council goals of academic excellence within physical therapy education.

The Education and Pedagogy Consortium (EPiC) focuses on exploring and promoting best practices of pedagogy and education delivery of physical therapy education.

The National Consortium of Clinical Educators (NCCE) serves as a resource and forum for individuals who have professional interest and responsibilities for the implementation and evaluation of clinical education for physical therapists, and advises ACAPT on matters of clinical education curriculum and policy. Membership is comprised of an academic and clinical educator pair for each ACAPT institution. ELC is the annual business meeting for the NCCE. The goal is for at least one member (ideally, both) of the institutional pair to be present for this meeting, and that 100% of ACAPT institutions will be represented. Others are welcome to attend.

ACAPT CONSORTIUM DESCRIPTIONS

National Interprofessional Education Consortium (NIPEC) shall advance physical therapy as an integral component of Interprofessional education and practice through collaboration with other organizations nationally and internationally. The consortium shall serve as a resource and forum for faculty at ACAPT member institutions involved in Interprofessional education efforts, and promote Interprofessional education and collaborative practice within the physical therapy community through APTA.

The Research-Intensive Programs in Physical Therapy Consortium (RIPPT) exists to promote research to improve healthcare and excellence in PT education, to serve as a forum for research-intensive programs to build and support their research enterprises and collaborations, to serve as a resource for programs that aspire to be research-intensive, and to develop accepted benchmarks of research activity.

EDUCATION SPECIAL INTEREST GROUPS DESCRIPTIONS

The Academic Faculty Special Interest Group (AF SIG) serves as a forum for sharing and exchanging information about faculty matters and as an advocacy group for academic faculty in addressing issues of concern in physical therapy education. The AFSIG has generated excitement among academic faculty from different content backgrounds to come together over issues of teaching, scholarship, and service.

The Anatomy Educators Special Interest Group (AE SIG) provides and on-line network for the exchange of information related to physical therapist anatomy education. The AE SIG fosters awareness of best-practice and teaching tools available to physical therapist anatomy educators. Efforts of the AE SIG are coordinated with existing anatomy professional organizations to ensure efficient use of available resources and the dissemination of education-related information. The AE SIG also fosters mentoring relationships between experienced and novice anatomy faculty and facilitates collaborative efforts among physical therapy anatomy educators.

The Clinical Education Special Interest Group (CE SIG) provides a vehicle for increasing and improving communication among clinical educators. The CE SIG works to promote cooperative efforts among educational programs and clinical sites in scheduling, evaluation, and continuing education. The CE SIG also serves as a resource body involved in acquiring, cataloguing, and disseminating information related to clinical education in physical therapy.

The Physical Therapist Assistant Educators Special Interest Group (PTAE SIG) serves as a resource and forum for individuals who have an interest in physical therapist assistant education. The PTAE SIG provides a vehicle for increasing and improving the communication among educators in Physical Therapist Assistant (PTA) programs. Through this increased communication, the PTAE SIG has promoted continuing education for PTA faculty in areas pertinent to their teaching responsibilities.

The Residency/Fellowship Education Special Interest Group (RFE SIG) provides a forum where residency/fellowship faculty including program directors, coordinators, and mentors will promote excellence in residency education by providing collaborative opportunities for educational research, exploring opportunities for curricular development, enhancing resident clinical reasoning skills, and discussing resources available for assessment in residency education. The RFE SIG is open to anyone (PT or PTA) who has an interest in residency and/or fellowship education from a clinical or academic standpoint. Members must be members of the Education Section. Meetings will be held twice per year at Combined Sections Meeting and the Educational Leadership Conference.

The Scholarship of Education Special Interest Group (SOE SIG) provides a forum where both academic and clinical educators will promote and enhance the quality of educational scholarship in physical therapist education. The SOE SIG seeks to foster the development of educational researchers and facilitate collaboration and translation of research to educational practice.

Acadaware, Ltd

Silver Sponsor | Table: 22

Acadaware offers a completely integrated Clinical Education, Curriculum Management and Assessment Package with immediate access to accreditation reporting easily closing the information loop.

APDM Wearable Technologies

Bronze Sponsor | Table: 26

APDM Wearable Technologies offers Opal movement sensors, Mobility Lab gait and balance analysis system and NEW Moveo Explorer kinematic system for joint range of motion

Cardon Rehabilitation & Medical Equipment Ltd.

Platinum Sponsor | Table: 10 & 15

Cardon welcomes the opportunity to deliver the highest valued return on your investment in our treatment tables and therapeutic exercise equipment.

Certiphi Screening, Inc.

Bronze Sponsor | Table: 19

Certiphi Screening developed and administers the APTA PTCAS Criminal Background Check Program and offers background checks, drug screening and immunization tracking solutions for individual schools.

DxR Development Group, Inc.

Bronze Sponsor | Table: 4

DxR Development demonstrates VirtualPT Clinician software, featuring 24 pre-authored, editable cases, plus case authoring and evaluation tools. Other offerings: courseware, testing, and test administration software.

Education Leadership Institute Fellowship

Bronze Sponsor | Table: 5

The APTA Education Leadership Institute (ELI) Fellowship is designed to provide new and aspiring program directors in physical therapy education programs with the skills and resources they need to be innovative, influential, and visionary leaders who can function within a rapidly evolving, politico-sociocultural environment.

Electro-Medical Equipment Inc/Assist Tables

Bronze Sponsor | Table: 9

ExamSoft

Bronze Sponsor | Table: 11

ExamSoft enables educators to efficiently and effectively create, administer, grade, and analyze assessments with the goal of improving student performance, curricular design, and accreditation compliance.

Exxact

Platinum Sponsor | Table: 23

Exxat makes education management software for programs in the Allied Health Sciences. Our platform helps PT departments save time, increase efficiency and improve educational outcomes.

EXHIBITORS

F.A. Davis Company

Bronze Sponsor | Table: 3

F.A. Davis Company publishes a collection of exceptional products for health professionals. Stop by our booth and receive 20% off or visit our website www.fadavis.com.

Federation Of State Boards Of Physical Therapy

Bronze Sponsor | Table: 12

FSBPT achieves public protection through regulation of physical therapy, tools and systems to assess entry-level and continuing competence, and awareness of public protection resources.

Jones & Bartlett Learning

Bronze Sponsor | Table: 21

Jones & Bartlett Learning is a world-leading provider of instructional, assessment, and learning-performance management solutions for the secondary education, post-secondary education, and professional markets.

Ohio Kentucky Consortium Of Physical Therapy Programs For Clinical Education

Bronze Sponsor | Table: 7

OKPTCE seeks to foster partnerships with clinicians to promote best practice in clinical education through mentorship, responsiveness to contemporary issues, and implementation of creative processes.

Nationwide Children's Hospital

Bronze Sponsor | Table 25

Nationwide Children's Hospital is one of America's largest not-for-profit freestanding pediatric healthcare systems and research institutes providing care for infants, children and adolescents.

Performance Health

Bronze Sponsor | Table: 14

Performance Health® manufacturer of Thera-Band® Systems of Progressive Exercise and Biofreeze® Pain Relieving Products, provides solutions for therapy, rehabilitation, daily living, and wellness, including products that help patients manage pain, improve strength and balance, and restore function. Break the pain cycle to encourage Active Care! Visit us at www.performancehealth.com for more details.

PT Cardiopulmonary Educators, LLC

Bronze Sponsor | Table: 1

PT Cardiopulmonary Educators is a web-based company providing quality cardiopulmonary education across several venues. A new component of the company offers cardiopulmonary education for entry-level Physical Therapy programs via webinars, a lab manual, and faculty facilitator.

PTCAS

Bronze Sponsor | Table: 6

PTCAS allows applicants to use 1 application and set of materials to apply to multiple physical therapist education programs.

PTNow

Bronze Sponsor | Table: 2

PTNow supports evidence-based practice by providing knowledge translation, patient care tools, and access to synthesized literature and original research in a responsive website.

PT-PAC

Bronze Sponsor | Table: 24

Be An Advocate for the Profession! Support Our Efforts on Capitol Hill through our grassroots programs and donating to PT-PAC.

Rehab Essentials, Inc.

Gold Sponsor | Table: 18

Rehab Essentials, the quintessential e-learning solution, partners with universities to provide cost-effective expert content, enabling faculty to flip their classrooms and cultivate applied learning experiences.

Scorebuilders

Gold Sponsor | Table: 8

Scorebuilders is the leader in preparation for the National Physical Therapy Examinations! Stop by our booth and explore our innovative PT and PTA product line!

SLACK Incorporated

Bronze Sponsor | Table: 13

SLACK Incorporated is a leading publisher in the area of Physical Therapy. We publish on a range of topics to be used in the classroom or as resources for clinicians. Visit our table to see what is new and best-selling. You may also visit us online at www.healio.com/books/pt.

TherapyEd

Gold Sponsor | Table: 16

The leader in exam preparation for the NPTE, TherapyEd gives on-campus prep courses and publishes the National Physical Therapy Examination Review & Study Guide by O'Sullivan and Siegelman.

Typhon Group, LLC

Bronze Sponsor | Table: 17

Typhon Group's AHST Student Tracking System is a comprehensive web-based application for student management, clinical skills tracking, evaluations, site placements, portfolios and more! Visit www.typhongroup.com.

University Of St. Augustine For Health Sciences

Bronze Sponsor | Table: 20

The University of St. Augustine for Health Sciences offers graduate level degrees in physical therapy, occupational therapy, nursing, education and health science, plus continuing education.

